

NEWPhase

Development LLC

Plastic products for the hobby, craft & floral industries
PRODUCT ORDER FORM

P.O. Box 756
 Rigby, ID 83442
 E-mail: wayne@newphasedev.com
 Phone: 208-932-0205
 Fax: 888-737-6681

BRIGHT
 Lights



Item #	UPC Code	Description	Min	Case	Retail/each	Quantity	Extended
○ 1101	814750011014	Submersible LED, Clear Light 2 Pack	4	96	\$3.99		
● 1163	814750011632	Submersible LED, Rainbow Light 12 Pack	4	24	\$23.99		
○ 1141	814750011410	Submersible LED, Clear Light 12 Pack	4	48	\$17.99		
● 1143	814750011434	Submersible LED, Pink Light 12 Pack	4	48	\$17.99		
● 1146	814750011465	Submersible LED, Blue Light 12 Pack	4	48	\$17.99		
● 1148	814750011489	Submersible LED, Green Light 12 Pack	4	48	\$17.99		
● 1149	814750011496	Submersible LED, Red Light 12 Pack	4	48	\$17.99		

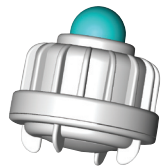

Color
 Select

3 colors in 8 combinations

1181	814750011816	Waterproof Color Select, 2 Pack	4	96	\$4.99		
1182	814750011823	Waterproof Color Select 5 Pack	4	48	\$11.65		

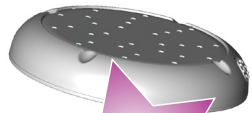

Vase
 Light

1201	814750012011	Vase Light, White Body (Special Order)	1	8	\$19.99		
1202	814750012028	Vase Light, Black Body	1	8	\$20.99		

Featuring black base
 vaselight and Bright Fill
 Moondrops #1360



Featuring Bright Fill
 Moondrops #1390



Item #	UPC Code	Description	Min	Case	Retail/each	Quantity	Extended
○ 1301	814750013018	Bright Fill, Moon Drops, Clear	4	24	\$6.99		
● 1305	814750013056	Bright Fill, Moon Drops, Baby Grand Black	4	24	\$6.99		
● 1320	814750013209	Bright Fill, Moon Drops, Hyacinth Violet	4	24	\$6.99		
● 1330	814750013308	Bright Fill, Moon Drops, Princess Pink	4	24	\$6.99		
● 1331	814750013315	Bright Fill, Moon Drops, Razzleberry Dark Pink	4	24	\$6.99		
● 1340	814750013407	Bright Fill, Moon Drops, Startled Orange	4	24	\$6.99		
● 1350	814750013506	Bright Fill, Moon Drops, Lemon Tingle Yellow	4	24	\$6.99		
● 1351	814750013513	Bright Fill, Moon Drops, Firelight Gold	4	24	\$6.99		
● 1360	814750013605	Bright Fill, Moon Drops, Celestial Blue	4	24	\$6.99		
● 1361	814750013612	Bright Fill, Moon Drops, Tanzanite Blue	4	24	\$6.99		
● 1380	814750013803	Bright Fill, Moon Drops, Peridot Light Green	4	24	\$6.99		
● 1390	814750013902	Bright Fill, Moon Drops, Imperial Red	4	24	\$6.99		
						Sub total	
						Tax	
						Shipping	
						Total	

Buyer's Name: _____

Company Name: _____

Address: _____

Phone: _____

E-mail: _____

Credit Card Type: _____

Name on Credit Card: _____

Credit Card Number: _____

Expiration Date: _____

Security Code: _____

NEWPhase
Development LLC

P.O. Box 756
Rigby, ID 83442

E-mail: wayne@newphasedev.com
Phone: 208-932-0205
Fax: 888-737-6681